



# City of Phoenix ODOT Brief - February 2022





# OR 99 COLEMAN CREEK IN PHOENIX

WE'RE BUILDING  
**A NEW  
BRIDGE!**

SIDEWALKS/BIKE LANES  
EXPECT SINGLE LANE  
TRAFFIC/SHORT DELAYS

DAYTIME CONSTRUCTION NOISE

*Consider using alternate routes*



[HTTPS://BIT.LY/33CGFIV](https://bit.ly/33CGFIV)



Questions?  
Gary.W.Leaming@odot.state.or.us  
541-621-3074







OR 99: Coleman Creek Bridge - Now through October





# OR 99: Coleman Creek Bridge

- \$3.5 million
- Wider roadway area
  - Adds - sidewalks and bike lanes
  - New under structure area of creek
  - Better fish-friendly crossing.

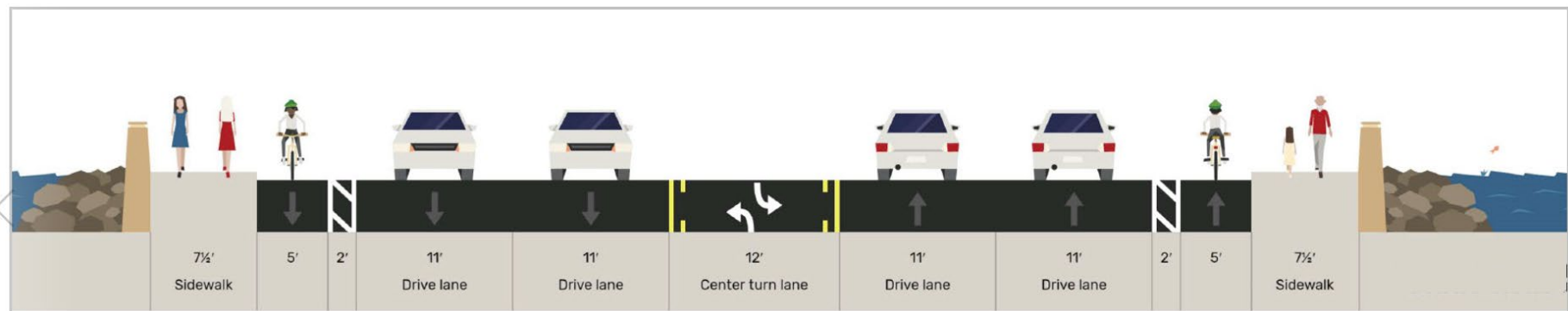

New cross section: Oregon 99 Coleman Creek Bridge

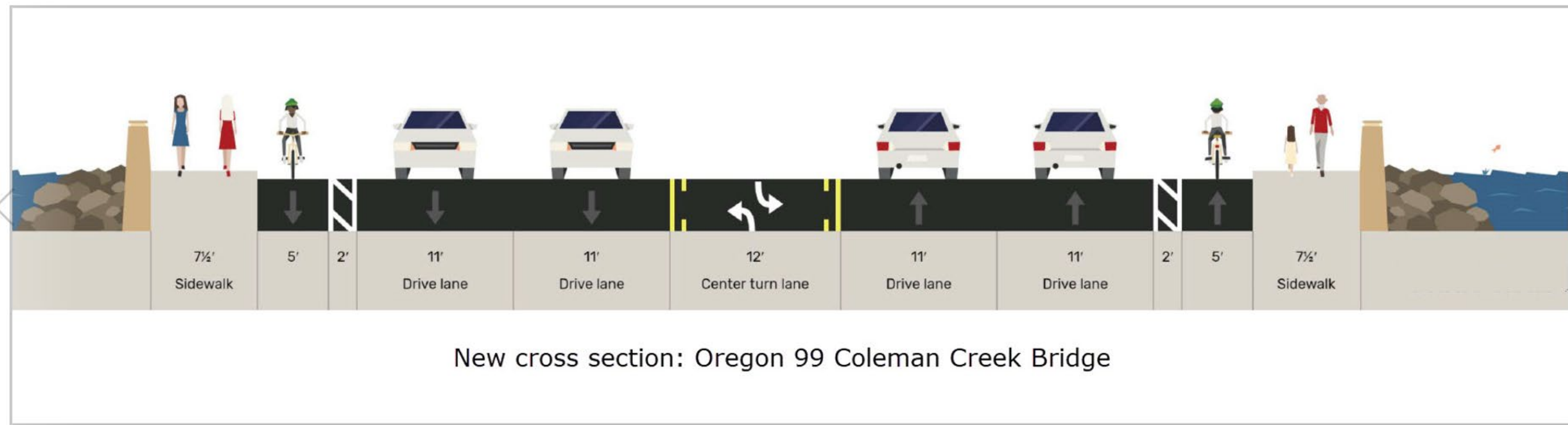

## OR 99: Coleman Creek Bridge Cross-section

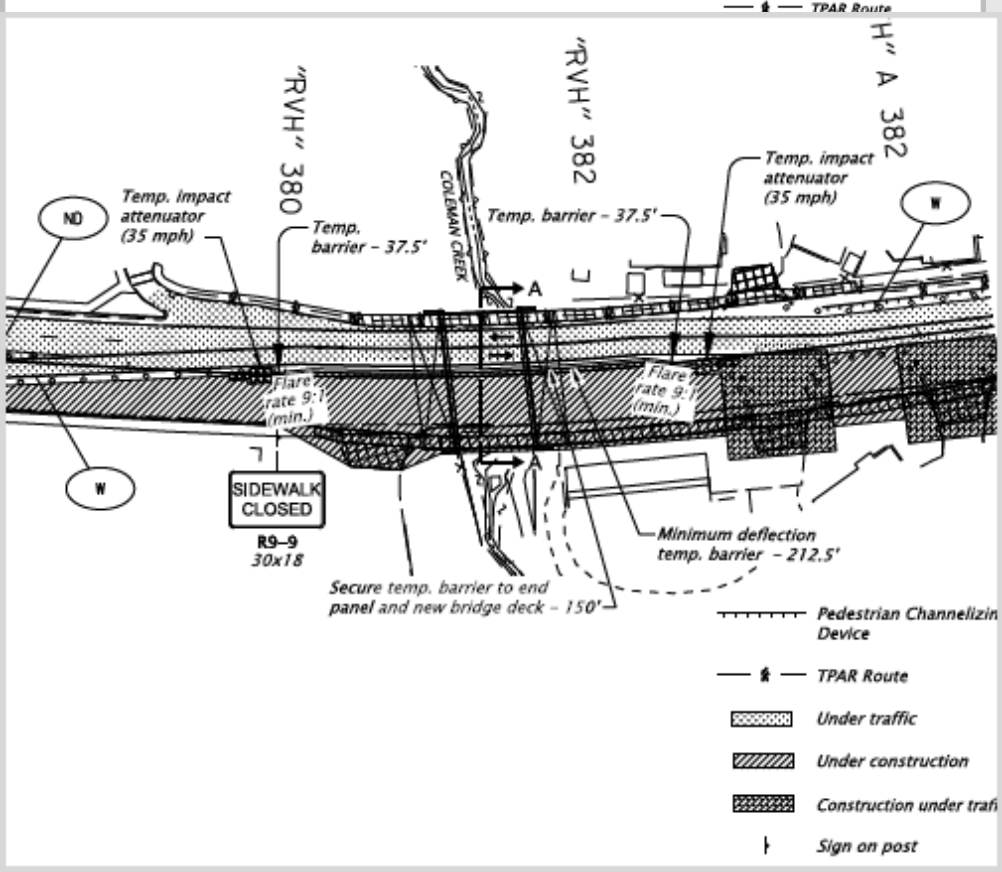
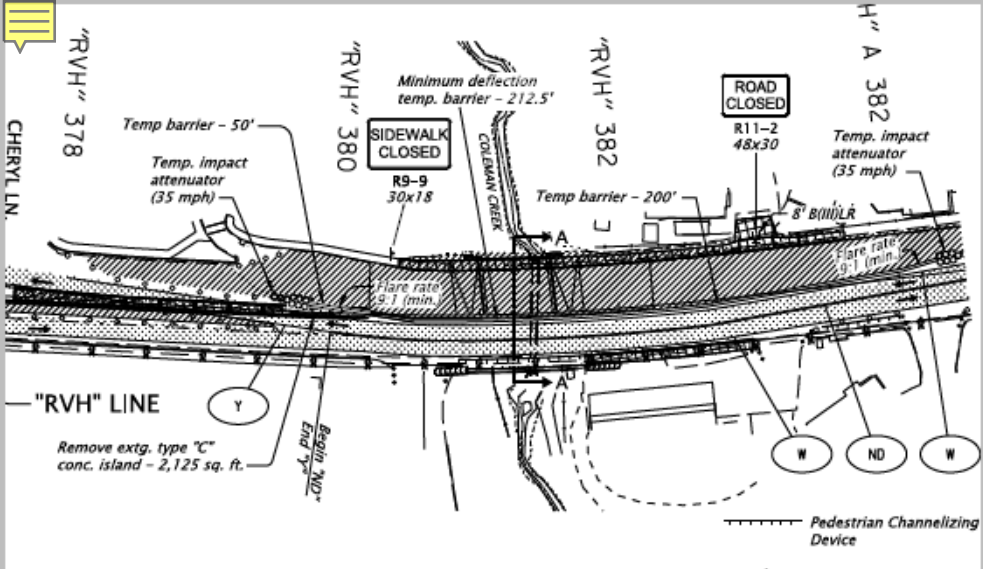

# Staged construction

- **Stage #1: February – June**
  - Traffic flow single lane each direction, eastside.
  - Contractor work on the west, or upstream side of the road, behind concrete barrier.
- **Stage 2: June-September 2022:**
  - Contractor may elect to remove the box culvert, allowing construction in the creek bed.
- Access to adjacent properties will be maintained.





## Fish Friendly\*

- Coleman Creek provides habitat capable of producing wild summer steelhead
- Existing culvert is a significant barrier to adult summer steelhead trying to move upstream to spawn
- Considered a total block to juvenile steelhead trying to migrate upstream to feed in Coleman Creek during the winter month.
- While not the only human-made barrier to fish migration and production, the culvert is the lower-most barrier and as such is the place where restoration starts.

- Per ODFW





## The new look under Coleman Creek Bridge

- Creek bed/banks will be rebuilt to “natural creek bed” – stumps, rocks, woody debris.

Kane Creek near Gold Hill





## The new look under Coleman Creek Bridge

- Areas where fish could rest as they make their way upstream to spawn.







## OR 99: Glenwood to Coleman Creek

- \$15 million
- In development
- Bids Dec. 2023
- Construction spring 2024



Coleman Creek





# OR 99: Glenwood to Coleman Creek

- Sidewalks and bike lanes
- Pedestrian Crossings –RRFB
- Bus pull outs
- Bids Dec. 2023
- Construction 2024







Before the  
Alameda Fire

© 2020 Google

Google Earth



Glenwood Road (15)

Northridge Terrace (10)

North Rose Street

Coleman Creek

After the  
Alameda Fire





# OR99: Rogue Valley Highway (Existing-70 feet wide...)

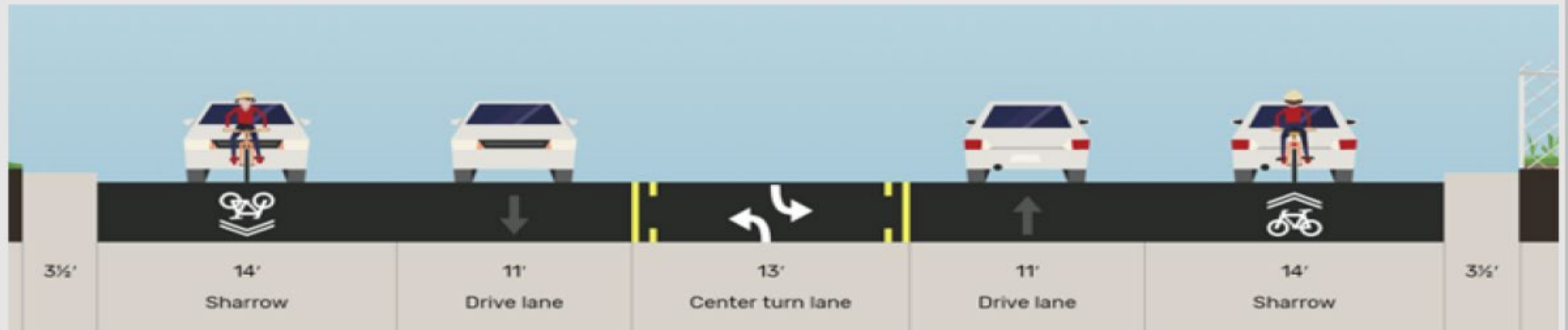

# OR99: Rogue Valley Highway (Proposed-85 feet wide)

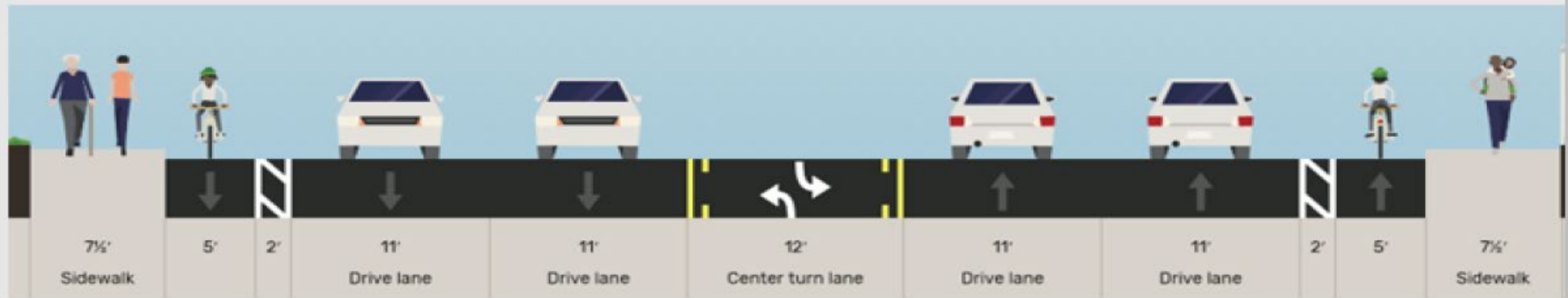

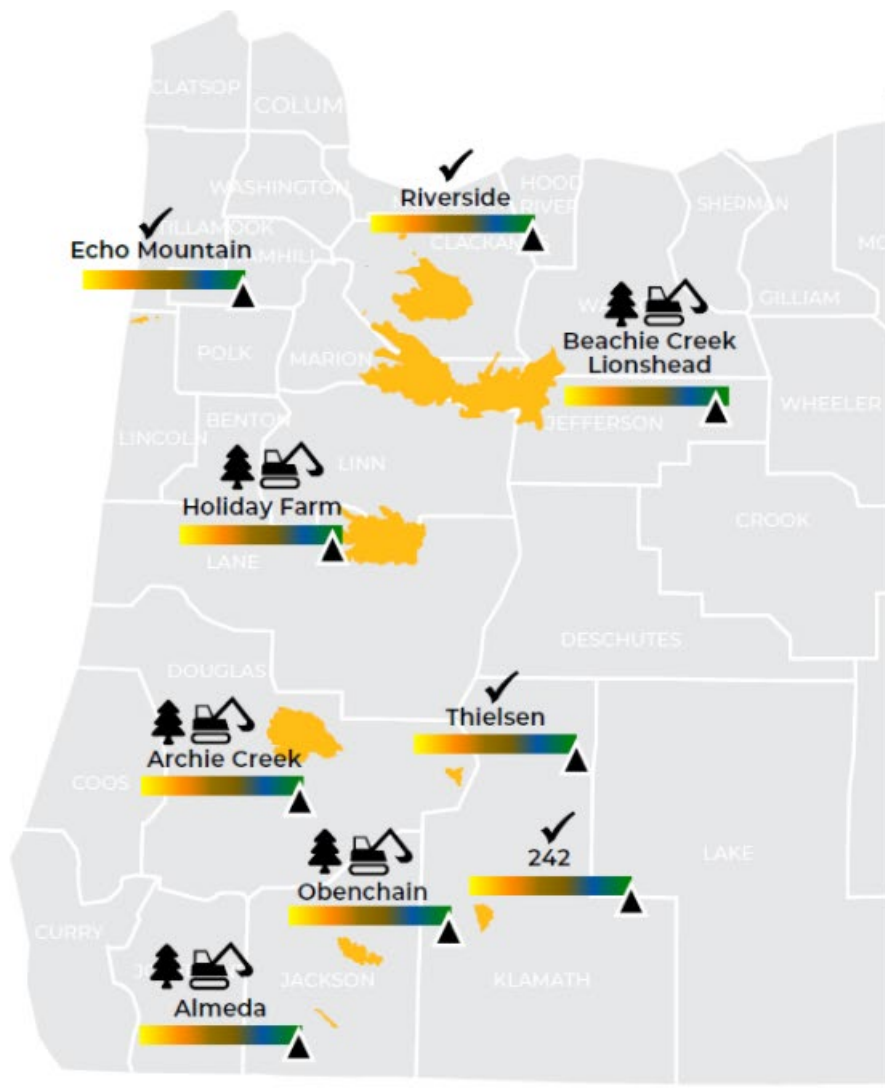

**3,006 lots** cleared throughout Oregon

**3,017 lots** currently participating in the Step 2 cleanup process



**85,474** hazard trees removed



**94,670** hazard trees estimated in total



**99.6% lots** cleared  
**90.3% hazard trees** removed statewide



**541 people** in the workforce, **71%** from Oregon

**96%** of cleanup work performed by **Oregon-based businesses**







THANK YOU!!